

# ENGINE

## CAMSHAFT TIMING BELT - K16 ENGINES

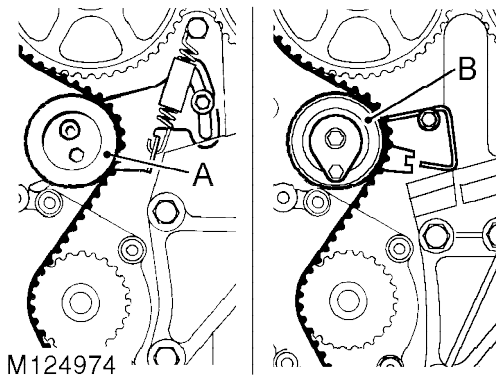

**NOTE:** Two types of timing belt tensioner are fitted to K16 engines, type A is a manual tensioner fitted to some K16 non VVC and all VVC engines. Type B is an automatic tensioner fitted to some K16 non VVC engines. Commencing engine numbers for the automatic tensioner are listed in Information. The tensioners and their timing belts are not interchangeable. The manual timing belt tensioner spring fitted to K16 non VVC engines is fitted with a sleeve, whilst on VVC engines only a spring is fitted.

Camshaft timing belt - manual tensioner - remove

**CAUTION:** Timing belts fitted to engines with manual timing belt tensioners are not interchangeable with belts fitted to engines with automatic tensioners.

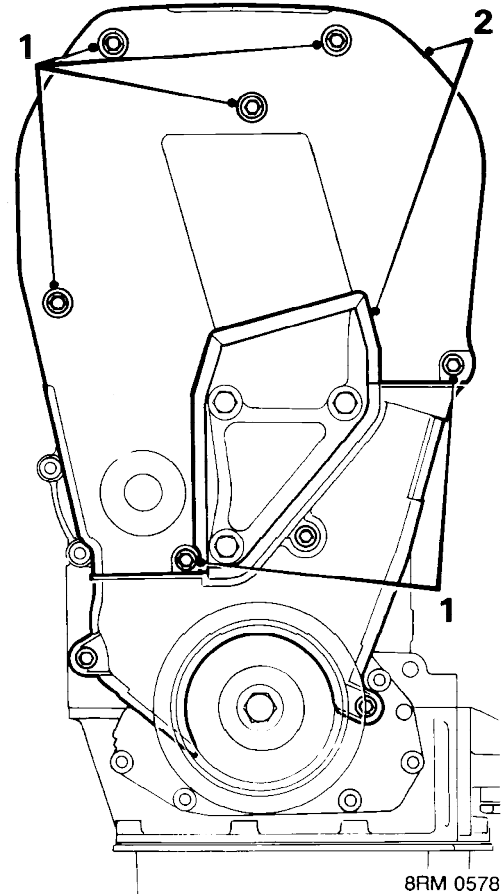

1. Slacken bottom bolt and remove 5 screws securing timing belt upper front cover.

**NOTE:** Remove bottom bolt when cover is not slotted.

2. Remove timing belt upper front cover and seal.

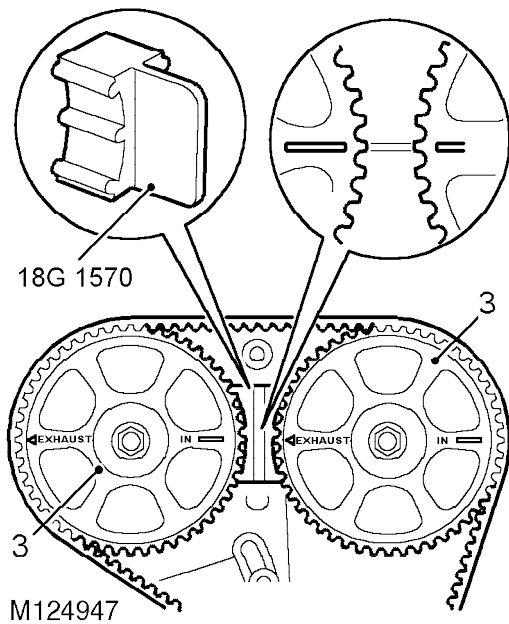

**NOTE:** VVC camshaft timing gear marks are shown in the inset on the illustration.

3. Rotate crankshaft clockwise to align camshaft gear timing marks - 90° BTDC.



**CAUTION:** Do not use camshaft gears, gear retaining bolts or timing belt to rotate crankshaft.

4. Fit camshaft gear locking tool 18G 1570.

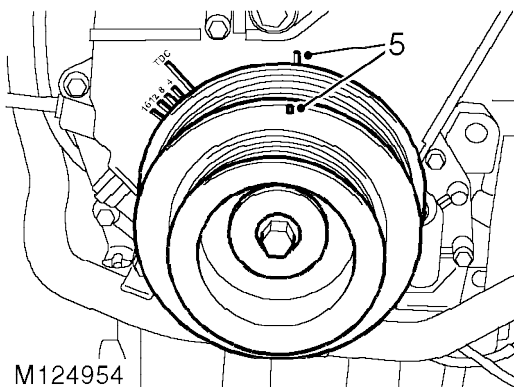

5. Check that timing mark on crankshaft pulley is aligned with mark on timing belt lower cover.

### Flywheel not fitted with a reluctor ring

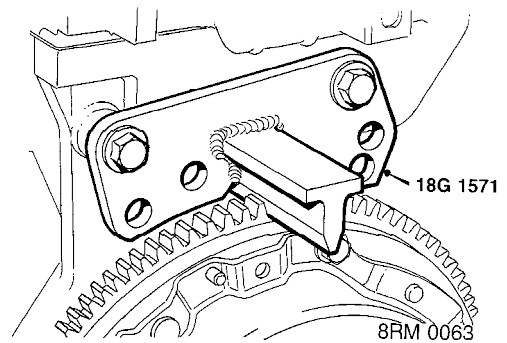

6. Fit flywheel locking tool 18G 1571.
7. Secure with 2 bolts.

### Flywheel fitted with a reluctor ring

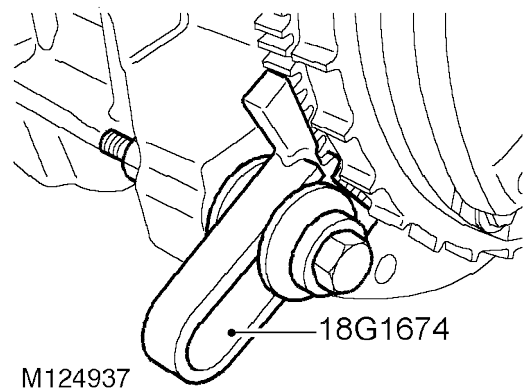

8. Fit flywheel locking tool 18G 1674, tighten bolt.



**CAUTION:** Ensure tooth on tool 18G 1674 engages with teeth on flywheel not the reluctor ring

# ENGINE

## All engines

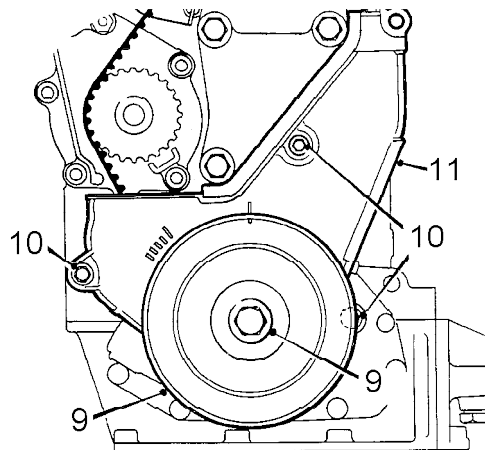

8RM3461A

9. Remove crankshaft pulley bolt and washer, remove crankshaft pulley.
10. Remove 3 bolts securing timing belt lower cover.
11. Remove timing belt lower cover together with seals.

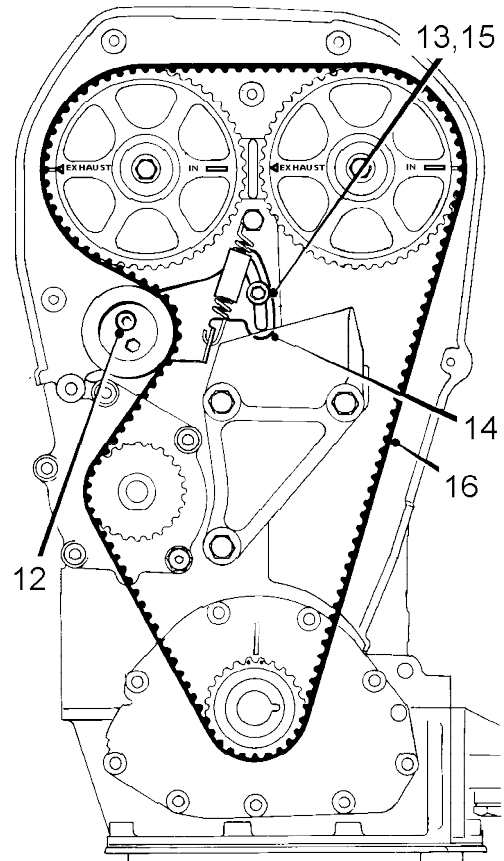

M124925



**NOTE: Non VVC camshaft timing gears and tensioner spring illustrated.**

12. Slacken tensioner pulley Allen screw.
13. Slacken tensioner backplate screw.
14. Push tensioner pulley down to fully OFF position.



**NOTE: VVC engines:- Tensioner spring and pillar bolt are only fitted for tensioning replacement timing belts.**

15. Tighten backplate screw to 10 Nm.
16. Ease timing belt from gears using the fingers only.
17. Discard timing belt.



**CAUTION: Timing belt must always be replaced during engine overhaul. Do not rotate crankshaft with timing belt removed and cylinder head fitted.**